

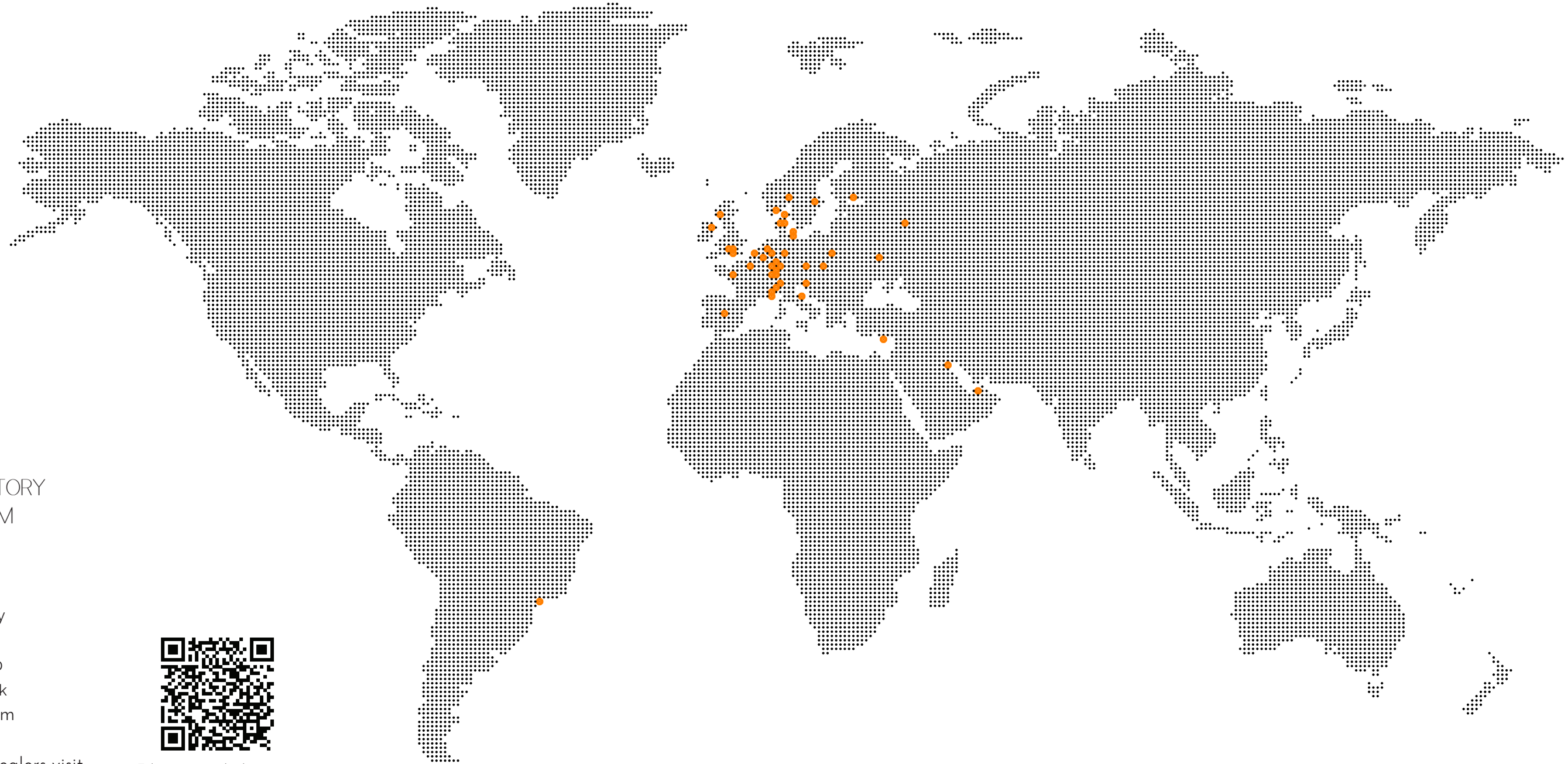

**decoflame**<sup>®</sup>  
*burning inspiration*

# DECOFLAME WORLDWIDE



## HEAD OFFICE, FACTORY and SHOWROOM

Decoflame ApS  
Stenholm 14  
9400 Nørresundby  
Denmark  
tel. +45 9630 4800  
info@decoflame.dk  
www.decoflame.com



Take a virtual showroom  
tour by scanning the code.

For a list of international dealers visit  
[www.decoflame.com](http://www.decoflame.com)

# ABOUT DECOFLAME

EXCEPTIONAL DESIGN COMBINED  
WITH CUTTING-EDGE TECHNOLOGY:  
THIS IS WHAT DECOFLAME IS STRIVING FOR.

- KJELL THOMSEN, CEO

Located in Northern Denmark, Decoflame was launched in 2008 and is today a leading manufacturer of high-end bioethanol fireplaces.

Decoflame applies its expertise and design competences in creating both standard and made-to-measure biofires for luxury property developments, private homes, as well as for the hospitality sector.

All Decoflame fireplaces are manually crafted and tested by highly skilled professionals, using premium quality materials. Equipped with various safety sensors, Decoflame fireplace combine cutting edge-technology with Scandinavian design.

With a well-established worldwide network, professional staff, comprehensive informative materials and technical specifications, Decoflame offers architects, interior designers as well as private customers, the perfect fireplace solution for every unique project.

# BIOETHANOL

## THE GREEN ALTERNATIVE

Bioethanol - or simply 'ethanol' is a renewable energy source made by fermenting the sugar and starch components of organic matter - mainly sugarcane, potatoes, and crops like grain. Depending on the agricultural structures of the producing country, it might also be made from milk, corn, rice, banana, grapes or even dates.

Today, bioethanol has many uses: Blended with petrol it makes transport fuel more sustainable, the cosmetics-, medical- and food industries use it in their production processes, and - last but not least - used in Decoflame fireplaces, it creates a beautiful dancing flame with a clean combustion.

### CLEAN EMISSION

When burning, bioethanol is dissolved into water and vapour carbon dioxide (CO<sub>2</sub>).

Carbon dioxide is absorbed by plants. It is then processed via photosynthesis to help the plant grow. This infinite cycle of creation and combustion of energy - in a way a recycling of energy - makes bioethanol a carbon-neutral fuel.

### EFFICIENT GREEN ENERGY

Due to the clean combustion of bioethanol, neither a flue nor a chimney are needed for Decoflame fireplaces - all the heat created is kept indoors. That is what makes bioethanol fires highly effective and efficient.

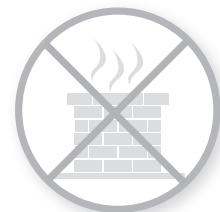

No chimney



No smell

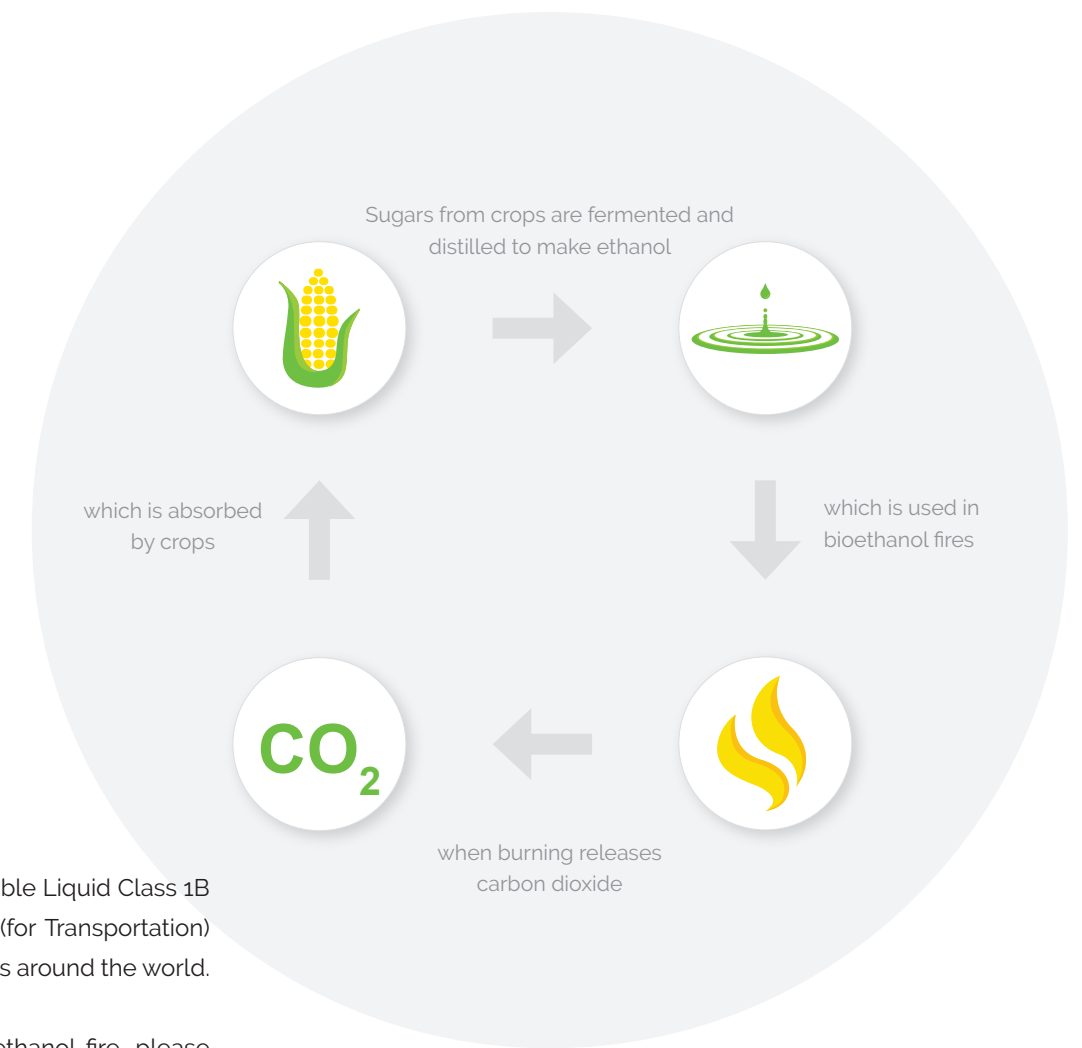

### STORAGE AND HANDLING

Bioethanol is classified as a Flammable Liquid Class 1B (for Flammability) and Class 3 PGII (for Transportation) and is regulated by various standards around the world.

Before operating a Decoflame bioethanol fire, please familiarise yourself and comply with these regulations in order to safely and legally store, handle, decant and use this fuel.

### ETHANOL VS. DENATURED ETHANOL

In line with various global regulations bioethanol of 100% purity cannot be sold in order to avoid human consumption.

Ethanol is therefore denatured with varying substances for retail purposes. It might be traded under names like Denatured Ethanol, Methylated Spirits, Denatured Alcohol, and others.

### BIOETHANOL AND DECOFLAME FIREPLACES

All Decoflame fireplaces can be operated only with bioethanol of at least 96% but max. 97.5% purity. We recommend Decoflame bioethanol, which has an alcohol percentage of 96.5%.

For more information on bioethanol or where to buy it, please contact us or visit:

[www.decoflame.com](http://www.decoflame.com)

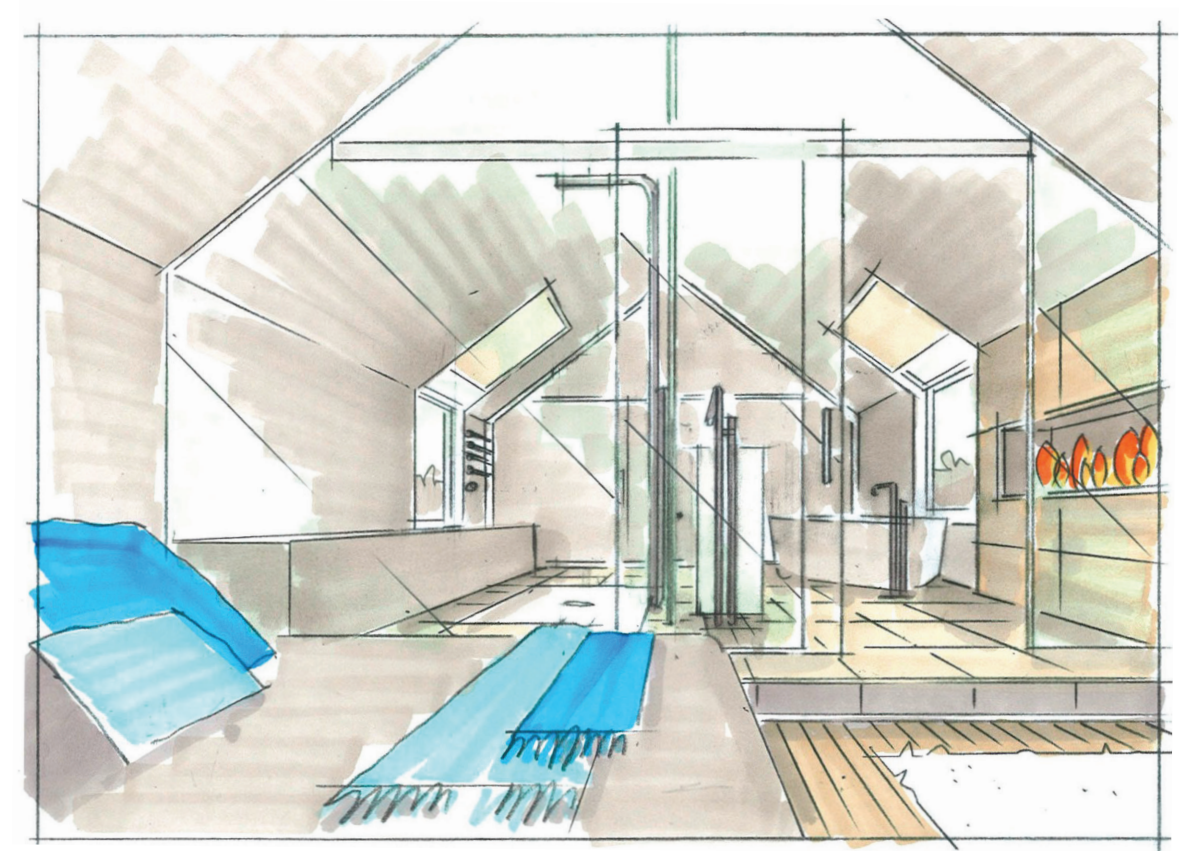

Montreal™ with the manual burner in the bathroom interior



Denver Ellipse™ being tested in DecoFlame's factory

# SAFETY

## A DECOFLAME PRIORITY

### SAFE TO OPERATE

Designed with functionality and consumer safety at our heart, all DecoFlame fires are thoroughly stress tested in our manufacturing line.

The manual DecoFlame burner features safety symbols/markings providing clearly understandable advice for safe operation of the product. The electronically controlled DecoFlame e-Ribbon Fire™ includes a highly developed safety system which ensures that dangerous user errors during operation of the fire are ruled out.

Regardless whether manual or highly advanced electronically controlled burner, all DecoFlame fireplace models come with a comprehensive User Manual in which every aspect from decanting the fuel, lighting the flame, regulating the flame to extinguishing the flame has been explained in order to provide peace of mind and facilitate a safe operation of the fire.

### OUR NUMBER ONE PRIORITY

As for all types of fireplaces, it is important to adhere to safety aspects when operating bioethanol fires. It is therefore essential to take the time to familiarise oneself with the safety procedures associated with using a DecoFlame fire and to educate other users of the appliance on bioethanol fireplace safety.

This type of fire technology is not well known and therefore we recommend that owners diligently induct any potential user of their fireplace to ensure everyone is aware of the potential hazards associated with using bioethanol as combustible.

### CREATING THE FUTURE

Through our participation as member of the European Expert Panel, which has been working on the development of a European Standard for bioethanol fires, we have not only been able to gain a unique insight in chemical and physical processes around bioethanol fires, but have also contributed significantly to the future safety of consumers operating bioethanol fires. With knowledge gathered from our work with biochemists and experts throughout the industry, we are able to create the safest bioethanol fires on the market, offering unique solutions for any fireplace application.





# READY-MADE COLLECTION

FREE-STANDING AND WALL-HUNG FIRES

EVERY DECOFLAME FIRE IS  
A DESIGN OBJECT THAT WILL TRANSFORM  
YOUR SPACE. IT'S JUST BEAUTIFUL.

- *BILL GRAHAM, CUSTOMER*

The ready-made collection consists of a large variety of floor models, wall- and ceiling mounted fireplaces, available in numerous finishes – offering an attractive fireplace solution for any taste, room size, layout and ambience.

In comparison to most bioethanol burners, all Decoflame fires feature a characteristic and uniquely wide, ribbon-like flame display.

Every single component of Decoflame fireplaces has been carefully designed and crafted – mainly of 304 grade stainless steel – which does not only look beautiful, but also lasts a lifetime.

All Decoflame fires are tested and manually adjusted in order to guarantee all-times functionality and safety. Additionally, a wide selection of fireplace models which have been thoroughly tested and safety certified by SITAC.







New York Empire™ in brass finish





New York Empire™



New York Plaza™



New York Tower™



*Ellipse Floor™ will add a style statement to any residence*





*Nice Square™ built-in burner is suitable for both indoors and outdoors*



*Ascot Lux™ fireplace insert*



Ascot Lux™

**Type:** Fireplace insert  
**Burner:** Manual  
**Dimensions:** WxDxH 462/562/662x337x370mm  
**Layout:** Open to front and back  
**Control:** Manual  
**Finish:** Black; Burner - Brushed stainless steel



Ellipse Floor™

**Type:** Free-standing  
**Burner:** Manual  
**Dimensions:** WxDxH 1120x400x650mm  
**Layout:** Open to front and back  
**Control:** Manual  
**Finish:** Black/White/RAL color



Chicago™

**Type:** Free-standing  
**Burner:** Manual  
**Dimensions:** WxDxH 1080x300x620mm  
**Layout:** Open to front and back  
**Control:** Manual  
**Finish:** Brushed stainless steel/Black/White



World™

**Type:** Free-standing  
**Burner:** Manual  
**Dimensions:** WxDxH 1080x320x540mm / 1080x380x660mm  
**Layout:** Open to front and back  
**Control:** Manual  
**Extra:** Wheels  
**Finish:** Brushed/Polished stainless steel/Black/White



Sydney™

**Type:** Free-standing  
**Burner:** Manual  
**Dimensions:** WxDxH 900x300x900mm  
**Layout:** Open to front and back  
**Control:** Manual  
**Extra:** Back plate  
**Finish:** Black/White/Brushed/Polished stainless steel/RAL color



Ellipse Ceiling™

**Type:** Ceiling-hung  
**Burner:** Manual  
**Dimensions:** WxDxH 1120x400x375mm and made-to-measure tube  
**Layout:** Open to front and back  
**Control:** Manual  
**Finish:** Black/White/RAL color



New York Tower™

**Type:** Wall-hung/built-in  
**Burner:** Manual  
**Dimensions:** WxDxH 600x150x800mm  
**Layout:** Open to front  
**Control:** Manual  
**Extra:** Glass  
**Finish:** Black/White/Polished/Brushed stainless steel/RAL color



New York Plaza™

**Type:** Wall-hung/built-in  
**Burner:** Manual  
**Dimensions:** WxDxH 900x150x590mm  
**Layout:** Open to front  
**Control:** Manual  
**Extra:** Glass  
**Finish:** Black/White/Polished/Brushed stainless steel/RAL color



New York Empire™

**Type:** Wall-hung/built-in  
**Burner:** Manual  
**Dimensions:** WxDxH 1150x150x590mm  
**Layout:** Open to front  
**Control:** Manual  
**Extra:** Glass  
**Finish:** Black/White/Polished/Brushed stainless steel/RAL color





Atlantic™

**Type:** Wall-hung  
**Burner:** Manual  
**Dimensions:** WxDxH 700x180x600mm  
**Layout:** Open to front  
**Control:** Manual  
**Finish:** Black; Burner - Brushed stainless steel



Atlantic Tower™

**Type:** Wall-hung  
**Burner:** Manual  
**Dimensions:** WxDxH 500x180x600mm  
**Layout:** Open to front  
**Control:** Manual  
**Finish:** Black/Brushed stainless steel

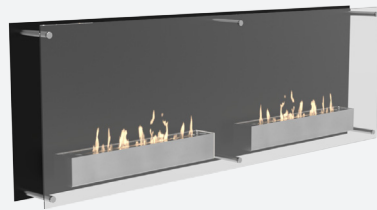

Atlantic Twin™

**Type:** Wall-hung  
**Burner:** Manual  
**Dimensions:** WxDxH 1700x180x550mm  
**Layout:** Open to front  
**Control:** Manual  
**Finish:** Black; Burner - Brushed stainless steel



Atlantic Wave™

**Type:** Wall-hung  
**Burner:** Manual  
**Dimensions:** WxDxH 700x133x600mm  
**Layout:** Open to front  
**Control:** Manual  
**Finish:** Black/Brushed stainless steel

**Decoflame ApS**  
Stenholm 14  
9400 Nørresundby  
Denmark  
tel. +45 9630 4800  
info@decoflame.dk  
www.decoflame.com

