

NEW

WINE IN50+
THE REFERENCE OF WINECELLAR
AIR CONDITIONNERS



- Air-conditions up to 50m³ and
Allows for the preservation of up to 5000 BOTTLES

- An energy consumption **30%**
LOWER than standard

air- conditioners

- **QUIETEST** unit on the market
- **BEST C.O.P.** performance of
the integrated air-conditioner market

-**LONGEVITY GUARANTEED**

thanks to exclusive technologies

WINE MASTER[®]
le temps d'être différent

www.fondis.com

SPECIAL OFFER

**Your complete duct
kit**

**FREE OF
CHARGE !**

For orders of model Wine IN50+ placed from october 10th to december 31st 2011, FONDIS offers you the complete duct kit **FREE OF CHARGE** (value 162€ H.T.)

THE ADVANTAGES OF THE IN50+ KIT

Important time savings

Easy to use

Optimal insulation

The kit includes :

**1 Straight pipe with muff- Ø 160 mm -
length 1000mm - IP 160/1000**

**2 telescopic wall crossings TMK
125/150 with shutter to sluice valves**

[IN ORDER TO KNOW MORE +](#) : [Discover the new kit](#)

- Offer valid from October 10th to December 31st, 2011 for all order of an air-conditioner IN50+. Kit delivered free of charge with with each ordered unit. Value 162€ public price. Within the limit of available stocks.

More precisions

Kit composition

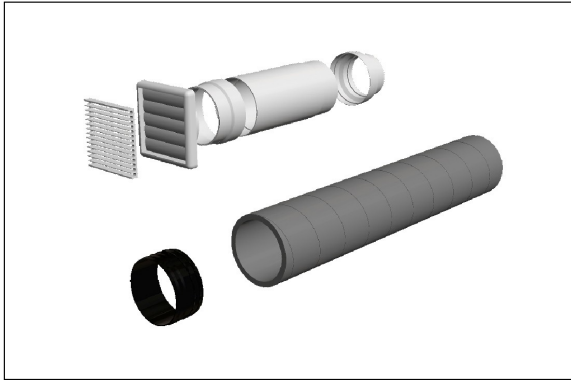

Composition of the basic kit (possibility of ordering additional parts)

- 2 grids kit with telescopic sleeve
- 1 meter straight pipe with muff

Drilling and installing grids and pipes - Cellular side

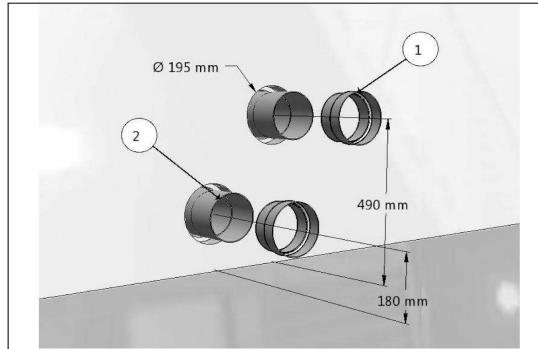

1. Reduction
2. Telescopic sleeve . Drill 2 holes diam 165 through the wall to pass the telescopic sleeves. Increase the diameter to 195mm in the insulation material to integrate the reduction

Drilling and installing grids and pipes – Outside

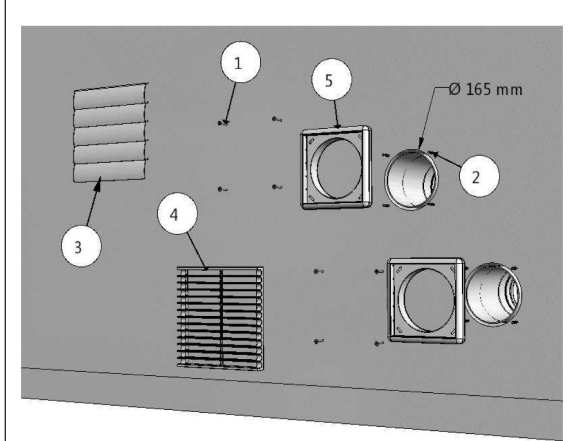

1. Screw diam 4
2. Ankles nylon
3. Plates
4. Roast
5. Frame (x2)

- place the frame -trace the clamp holes
- Drill the wall -fix the frames
- mount the grids

Assembly details

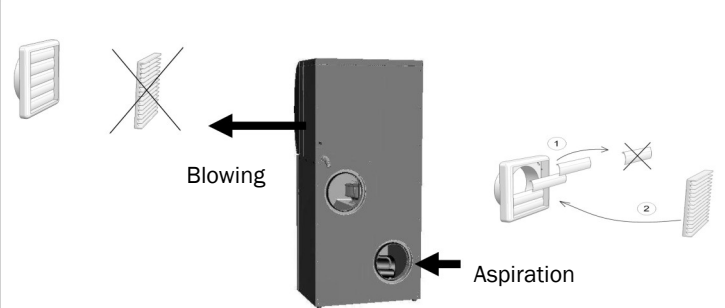

Attention, each case is composed of 2 grids (blowing and aspiration). it is necessary to adapt the type of grid

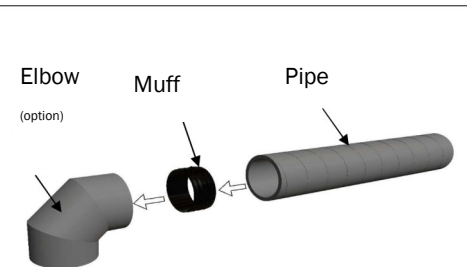

Cut the pipe according to the type of installation. Assembly the various elements with the sleeves

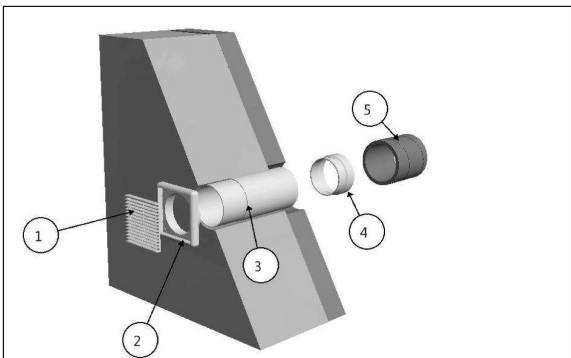

1. Grids
2. Frame
3. Telescopic sleeve
4. Reduction
5. Insulated pipe

Connect the 2 pipes on the reduction - fill the vacuum between the telescopic sleeve and the hole of the wall thanks to insulating material.

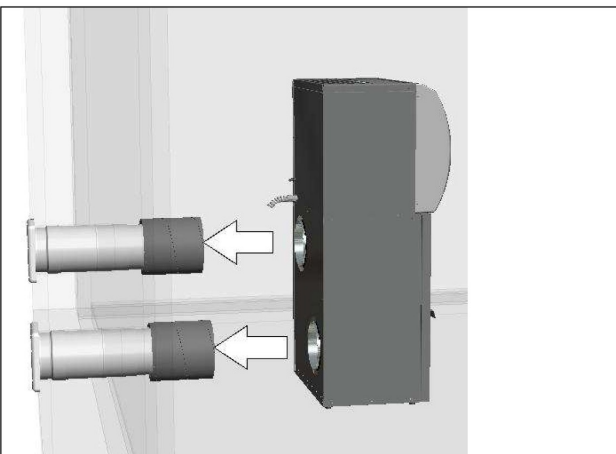

Fix the air-conditioner on to the isolated pipes.

There is no collar, the pipes are equipped with lip seals