



5712003



5712003E



cm 60x40
Stainless steel grid



kg 310



6/8



82x60 H.102



64



42

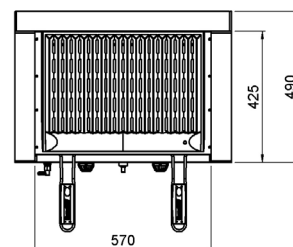
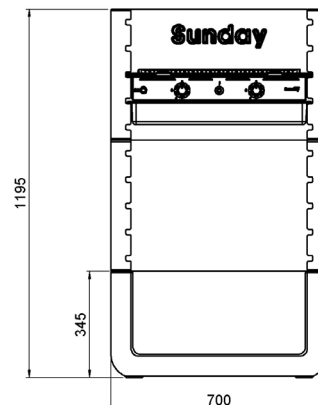
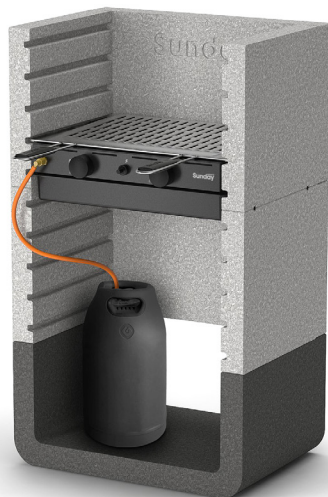

A barbecue equipped with the exclusive SUNDAY® DUO system for cooking with gas and with charcoal. The structure of the product comes in natural colours and is made of BIANCO CARRARA granulated marble, while the base is made of grey reconstituted stone. It is equipped as standard with a grill with two burners with piezoelectric ignition. It comes with a stainless steel biological grille with comfort handles and an enamelled brazier for dual function charcoal support and fat collection. It is easy to assemble with SUNDAY® BETONFAST glue that can be purchased separately among the wide range of accessories dedicated to the SUNDAY® ONE line.



To be used with GPL gas



Charcoal-burning



Quick and easy assembly



Stainless steel steak grill



DUO System

COMPONENTS

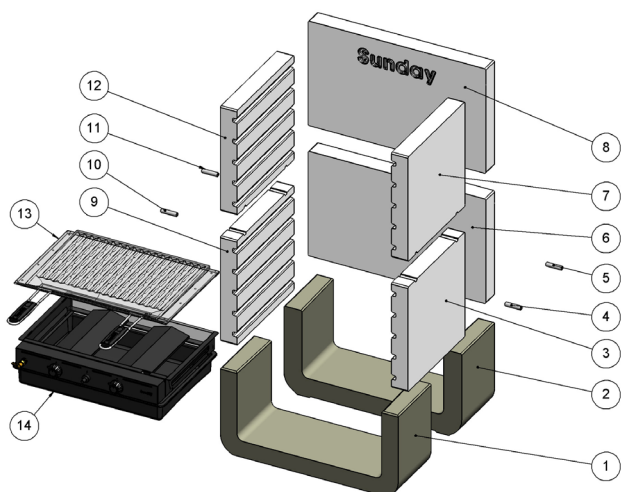

NR.	DESCRIPTION	CODE
1/2	BASE	27120290SA
3/7/9/12	SIDE	27120070BI
6/8	BACKSIDE	27120100BI
4/5/10/11	BUSHING	1201204100
13	STAINLESS STEEL GRILL 60x40	1401322400
14	GAS GRILL DUO SUNDAY	5612001